

ROLLER CHAIN WITH ATTACHMENTS

K 1 Single Hole Bent Lug Attachment

Base Chain Ref.	TIDC Chain No	Pitch (P)	ATT.Width (A)	Hole Diameter (B)	Plate Height (C)	Hole Pitch (D)	Overall Width (E)	Plate Thickness
06B	D 061 01 K1 02	9.525	8.00	3.50	6.50	19.00	27.00	1.03
08B	D 083 01 K1 05	12.70	9.50	4.30	8.40	28.20	37.20	1.40
10B	D 101 01 K1 02	15.875	14.10	5.20	10.40	31.80	47.60	1.53
12B	D 120 01 K1 04	19.05	15.85	5.60	12.00	35.00	51.60	1.90
16B	D 160 01 K1 05	25.40	19.00	6.80	15.90	50.80	74.80	3.00
40	D 08A 01 K1 05	12.70	9.525	3.18	7.92	25.40	35.31	1.52
50	D 102 01 K1 05	15.875	12.70	5.16	10.31	31.75	46.02	2.03
60	D 121 01 K1 04	19.05	15.875	5.16	12.14	38.10	54.23	2.39
80	D 161 01 K1 05	25.40	19.05	6.35	15.875	50.80	69.85	3.18

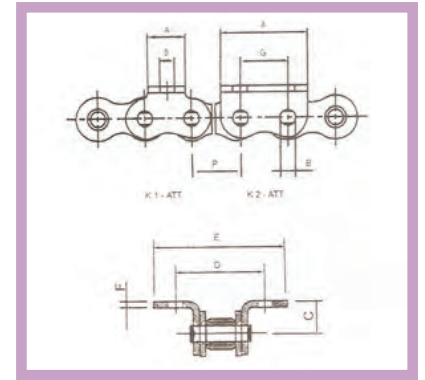

K2 Two Hole Bent Lug Attachments

Base Chain Ref.	TIDC Chain No	Pitch (P)	ATT.Width (A)	Hole Diameter (B)	Plate Height (C)	Hole Pitch (D)	Overall Width (E)	Plate Thickness (F)	Hole Pitch (G)
06B	D 061 01 K2 01	9.525	17.55	3.50	6.50	19.00	27.00	1.03	9.50
08B	D 083 01 K2 03	12.70	23.05	4.30	8.40	28.20	37.20	1.40	12.70
10B	D 101 01 K2 01	15.875	28.60	5.20	10.40	31.80	47.60	1.53	15.90
12B	D 120 01 K2 04	19.05	34.90	5.60	12.00	35.00	61.00	1.90	19.00
16B	D 160 01 K2 16	25.40	45.85	6.80	15.90	50.80	78.20	3.00	25.40
40	D 08A 01 K2 01	12.70	24.03	3.18	8.28	25.40	34.70	1.52	12.70
50	D 102 01 K2 01	15.875	30.76	5.16	10.31	31.75	45.90	2.03	15.875
60	D 121 01 K2 04	19.05	36.07	5.16	12.14	38.10	54.23	2.39	19.05
80	D 161 01 K2 10	25.40	47.88	6.35	15.875	50.80	69.85	3.18	25.40

M1 Single Hole Straight Lug Attachments

Base Chain Ref.	TIDC Chain No	Pitch (P)	ATT.Width (A)	Hole Diameter (B)	Hole Pitch (C)	Overall Width (D)	Plate Thickness (E)
06B	D 061 01 M1 01	9.525	8.00	3.50	9.50	13.50	1.03
08B	D 083 01 M1 02	12.70	9.50	4.30	14.10	19.20	1.40
10B	D 101 01 M1 02	15.875	14.10	5.20	15.90	23.70	1.53
12B	D 120 01 M1 02	19.05	15.85	5.60	17.90	26.20	1.90
16B	D 160 01 M1 03	25.40	19.00	6.80	26.00	35.00	3.00
40	D 08A 01 M1 02	12.70	9.525	3.18	12.42	17.37	1.52
50	D 102 01 M1 02	15.875	12.70	5.16	15.70	22.73	2.03
60	D 121 01 M1 02	19.05	15.875	5.16	18.19	26.37	2.39
80	D 161 01 M1 03	25.40	19.05	6.35	24.59	34.01	3.18

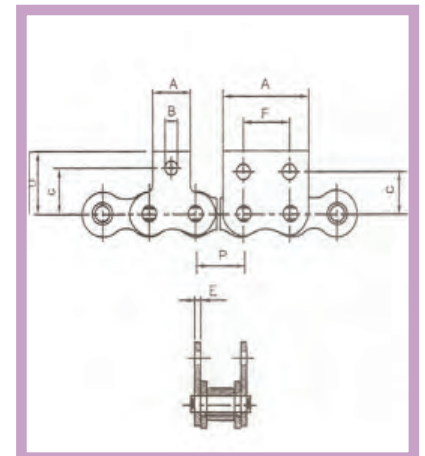

M2 Two Hole Straight Lug Attachments

Base Chain Ref.	TIDC Chain No	Pitch (P)	ATT.Width (A)	Hole Diameter (B)	Hole Pitch (C)	Att. Height (D)	Plate Thickness (E)	Hole Pitch (F)
08B	D 083 01 M2 03	12.70	23.05	4.30	14.10	19.20	1.40	12.70
10B	D 101 01 M2 01	15.875	28.60	5.20	15.90	23.70	1.53	15.90
12B	D 120 01 M2 02	19.05	34.90	5.60	17.90	31.85	1.90	19.00
16B	D 160 01 M2 02	25.40	45.85	6.80	26.00	36.75	3.00	25.40
40	D 08A 01 M2 01	12.70	24.03	3.18	12.78	17.37	1.52	12.70
50	D 102 01 M2 01	15.875	30.76	5.16	15.70	22.73	2.03	15.875
60	D 121 01 M2 01	19.05	36.07	5.16	18.19	26.37	2.39	19.05
80	D 161 01 M2 01	25.40	47.88	6.35	24.56	34.01	3.18	25.40

ATTACHMENT CHAINS

DOUBLE PITCH K1 ATTACHMENTS

ANSI B 29.4 OUTER attachment for American series

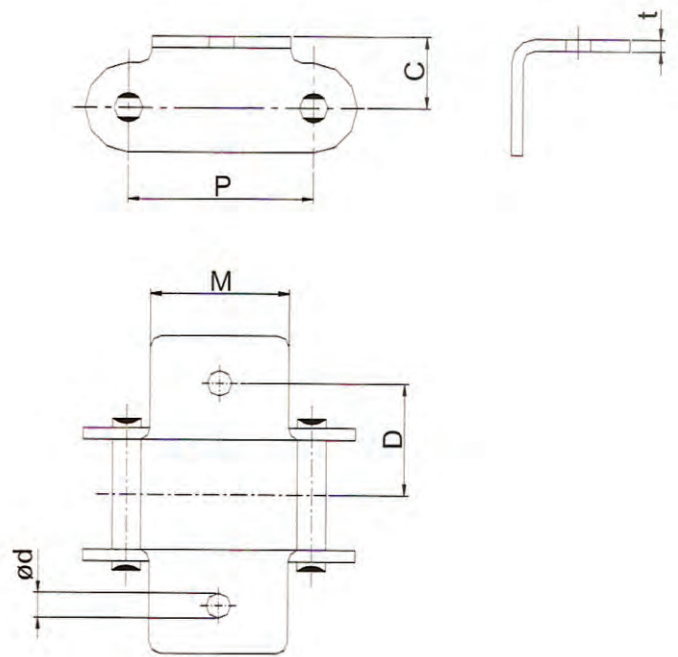
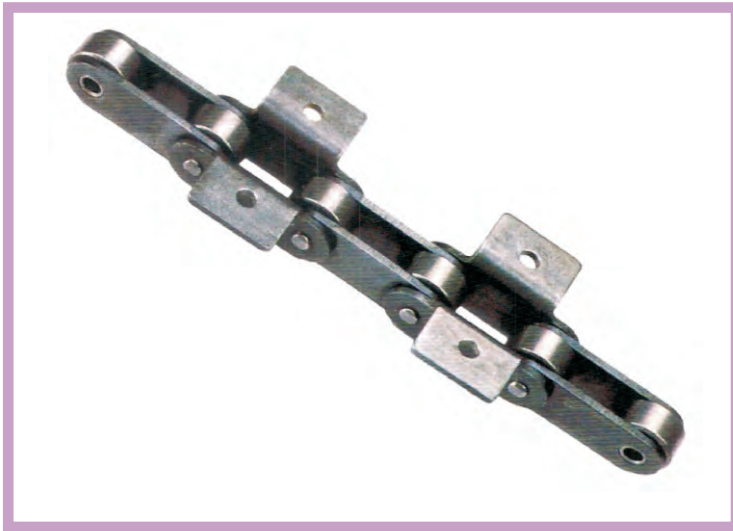

Base Chain Model	DIAMOND ATT. No	Pitch (P)	Thickness (t)	M	d	D	C
C2040	32-A 08 01 BK1	25.40	1.50	19.10	3.33	12.70	9.12
C2042							
C2050	32-A 102 01 K101	31.75	2.00	23.80	5.08	15.83	11.13
C2052							
C2060	32-A 121 01 K101	38.10	2.39	28.60	5.08	21.44	14.68
C2062							
C2060H	32-A 122 01 K101	38.10	3.15	28.60	5.08	21.44	14.68
C2062H							
C2080	32-A 161 01 K101	50.80	3.15	38.10	6.63	27.79	19.05
C2082							
C2080H	32-A 162 01 BK1 01	50.80	4.00	38.10	6.63	27.79	19.05
C2082H							
C2100	32-A 201 01 K101	63.50	4.00	47.60	8.20	33.32	23.42
C2102							
C2100H	32-A 202 01 K101	63.50	4.70	47.60	8.20	33.32	23.42
C2102H							
C2120	32-A 241 01 K101	76.20	4.70	57.20	9.80	39.67	27.79
C2122							
C2120H	32-A 242 01 K101	76.20	5.56	57.20	9.80	39.67	27.79
C2122H							
C2160	32-A 321 01 K101	101.60	5.56	76.20	13.11	52.37	36.53
C2162							
C2160H	32-A 322 01 K101	101.60	7.14	76.20	13.11	52.37	36.53
C2162H							

Note : Please select the required attachment plate and specify the frequency of positioning the attachments while ordering for chains.

ATTACHMENT CHAINS

DOUBLE PITCH K2 ATTACHMENTS

ANSI B29..4 Outer attachments for American Series

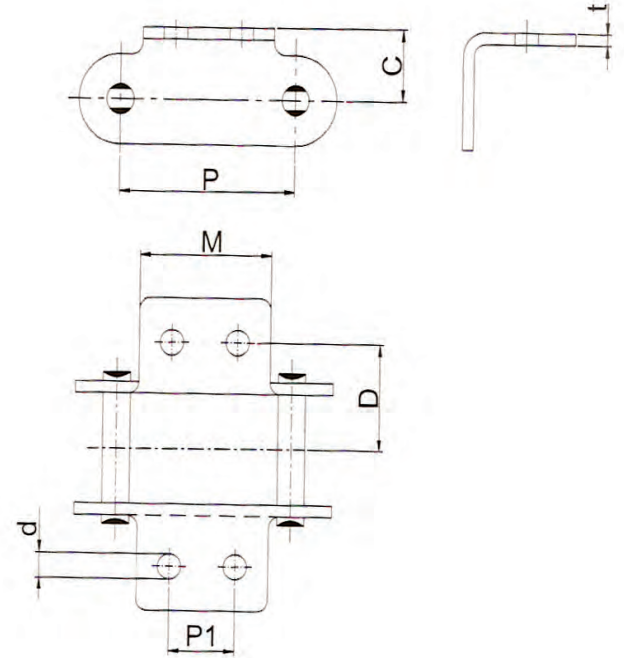
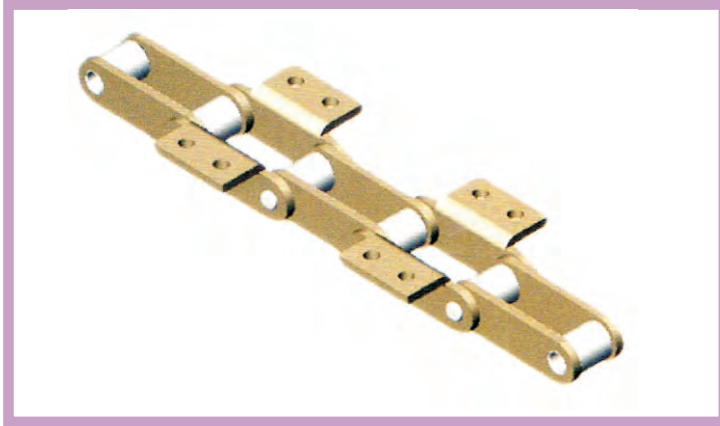

Base Chain Model	DIAMOND ATT. No	Pitch (P)	Thickness (t)	M	d	D	C	P1
C2040	32-A 08A 01 K2 01	25.40	1.50	19.10	3.33	12.70	9.12	9.52
C2042								
C2050	32-A 102 01 SK2	31.75	2.00	23.80	5.08	15.83	11.13	11.91
C2052								
C2060	32-A 121 01 SK2	38.10	2.39	28.60	5.08	21.44	14.68	14.30
C2062								
C2060H	32-A 122 01 K2 01	38.10	3.15	28.60	5.08	21.44	14.68	14.30
C2062H								
C2080	32-A 161 01 K2 01	50.80	3.15	38.10	6.63	27.79	19.05	19.05
C2082								
C2080H	32-A 162 01 K2 05	50.80	4.00	38.10	6.63	27.79	19.05	19.05
C2082H								
C2100	32-A 201 01 K2 01	63.50	4.00	47.60	8.20	33.32	23.42	23.83
C2102								
C2100H	32-A 202 01 K2 01	63.50	4.70	47.60	8.20	33.32	23.42	23.83
C2102H								
C2120	32-A 241 01 K2 01	76.20	4.70	57.20	9.80	39.67	27.79	28.58
C2122								
C2120H	32-A 242 01 K2 01	76.20	5.56	57.20	9.80	39.67	27.79	28.58
C2122H								
C2160	32-A 321 01 K2 01	101.60	5.56	76.20	13.11	52.37	36.53	38.10
C2162								
C2160H	32-A 322 01 K2 01	101.60	7.14	76.20	13.11	52.37	36.53	38.10
C2162H								

Note : Please select the required attachment plate and specify the frequency of positioning the attachments while ordering for chains.